



ALL PC ITEMS ARE FOR INFORMATION ONLY. PC ITEMS IS SHOWN AS PC ITEMS (STAGE 2) AND NOT PART OF THE TENDER PRICE. REFER TO SPEC. FOR DETAILS

GENERAL NOTES:

- IT IS CONTRACTOR'S RESPONSIBILITY TO WORK WITH EXISTING SITE CONDITIONS INCLUDING EXISTING DIMENSIONS ONSITE.
- CONTRACTOR TO CHECK AND CONFIRM DIMENSIONS WITH EXISTING DRAWINGS AND MATERIALS INSTALLED TO ORDERING & INSTALLATION OF MATERIALS.
- CONTRACTOR TO REFER TO STRUCTURAL ENGINEER'S DRAWINGS AND SPECIFICATIONS FOR ANY STRUCTURAL SCOPE OF WORKS AND REQUIREMENTS.
- CONTRACTOR TO REFER TO ELECTRICAL ENGINEER'S DRAWINGS AND SPECIFICATIONS FOR ANY ELECTRICAL SCOPE OF WORKS AND REQUIREMENTS.
- CONTRACTOR TO REFER TO MECHANICAL ENGINEER'S DRAWINGS AND SPECIFICATIONS FOR ANY MECHANICAL SCOPE OF WORKS AND REQUIREMENTS.
- CONTRACTOR TO REFER TO CIVIL ENGINEERS DRAWINGS AND SPECIFICATIONS FOR ANY CIVIL SCOPE OF WORKS AND REQUIREMENTS.
- IF UN-CLEAR REGARDING ANY PART OF SCOPE OF WORKS, CONTRACTOR'S MUST CONTACT ARCHITECT OR RELEVANT CONSULTANTS FOR CLARIFICATIONS PRIOR TO COMMENCING THE WORKS.
- IT IS CONTRACTOR'S RESPONSIBILITY TO RETRY THE WORKS IF CONTRACTOR CARRIED OUT THE WORKS IN ACCORDANCE WITH ARCHITECT AND RELEVANT CONSULTANTS.
- CONTRACTOR TO ALLOW SAW-CUT EXISTING CONCRETE SLAB AS REQUIRED BY STRUCTURAL ENGINEER'S DRAWINGS AND SPECIFICATIONS. CONTRACTOR TO ALSO INCLUDE SAW-CUTTINGS OF EXISTING CONCRETE SLAB TO PROVIDE A CHANGING ROOM FOR INSTALLATION OF PLUMBING WORKS.
- CONTRACTOR TO ALLOW EXISTING CONCRETE FLOOR GRADING AND LEVELING TO EXISTING FLOOR SLAB IN MALE & FEMALE CHANGING ROOM FOR FLOOR WASTES.
- CONTRACTOR TO SUPPLY & INSTALL NEW 2100mm HIGH HOPE TEMPORARY FENCE ON LEVEL 1 & FENCE OFF CONSTRUCTION AREA AT FOR THE DURATION OF THE PROJECT.
- CONTRACTOR TO REMOVE ALL TEMPORARY FENCE AT THE COMPLETION OF THE PROJECT.
- [PC ITEM] ALL FIXED JOINERY SHOWN ARE FOR INFORMATION ONLY.
- DETAILS OF ALL FIXED JOINERY TO BE CHECKED AND CONFIRMED WITH ARCHITECT AFTER TENDER.
- [SEPARATE CONTRACT] ALL LOOSE FURNITURES SHOWN ARE FOR INFORMATION ONLY, INCLUDING, TABLES, CHAIRS, RUBBER BINS, LOOSE ADJUSTABLE WORKSTATION DESKS, WHITEBOARDS, MOBILE PERIPHERALS, METAL FILING CABINETS, ALL LOOSE FURNITURE TO BE TENDER OUT AS A SEPARATE CONTRACT AT A LATER DATE.
- [PC ITEM] SUPPLY & INSTALL NEW FLOOR FINISHES TO EXISTING FLOOR FINISHES INCLUDING CARPET, FLOOR SHEET VINYL & FLOOR TILES.
- FLOOR FINISHES AND EXTENT TO BE SELECTED AND CONFIRMED AT LATER DATE.

NOTES: SCOPE OF WORKS

- [1] SUPPLY & LAY NEW CONCRETE PAVING TO EXISTING DRIVEWAY (REFER TO STRUCTURAL ENGINEER'S DRAWINGS FOR DETAILS).
- [2] SUPPLY & INSTALL NEW STEEL STUD PARTITION WALLS INCLUDING SOLID-CORE DOOR FRAMES, SHIPING FURNISHED ALUMINIUM DOORS, SLIDING DOOR, SLIDING DOOR TRACK AND ARCHITECTURAL WALL SET-OUT PLANS FOR DETAILS.)
- [3] [PC ITEM] SUPPLY & INSTALL NEW FIXTURES AND FITTINGS THROUGHOUT BOTH MALE AND FEMALE CHANGING ROOMS INCLUDING: VANITY BASKIN, VANITY BENCHES, TOILET PARTITIONS AND PARTITION DOORS, HAND DRYER, SOAP DISPENSER, TOILET PAPER HOLDER, TOILET RECESSED SUITES, SHOWER SCREEN DOORS, SHOWER BASE, VANITY WALL PARTNER & WALL TILES.
- [4] [PC ITEM] SUPPLY & INSTALL NEW EXTERNAL AUTOMATIC SLIDING DOOR TO GYM, INCLUDING GLAZING, ANODISED ALUMINIUM FRAMES, SLIDING DOOR, SLIDING DOOR TRACK AND MOTOR, SIDE GLAZINGS.
- [5] [PC ITEM] SUPPLY & INSTALL NEW JOINERY, INCLUDING CUPBOARDS, OVERHEAD CUPBOARDS, HANDLES, NEW WALL TILES.
- [6] [PC ITEM] SUPPLY & INSTALL NEW EXTERNAL AUTOMATIC SLIDING DOOR TO GYM, INCLUDING GLAZING, ANODISED ALUMINIUM FRAMES, SLIDING DOOR, SLIDING DOOR TRACK AND MOTOR, SIDE GLAZINGS.
- [7] [PC ITEM] SUPPLY & INSTALL NEW EXTERIOR DOOR TO GYM, INCLUDING GLAZING, ANODISED ALUMINIUM FRAMES, SLIDING DOOR, SLIDING DOOR TRACK AND MOTOR, SIDE GLAZINGS.
- [8] [PC ITEM] SUPPLY & INSTALL NEW JOINERY PARTITION INSIDE COMPUTER LAB, DETAILS AND FINISHES TO BE SELECTED.
- [9] [PC ITEM] SUPPLY & INSTALL NEW JOINERY, INCLUDING BENCHTOP, UNDERBENCH CUPBOARDS, CUPBOARD DOORS, OVERHEAD SHELVES FOR BOOKSHOP COUNTER.
- [10] SUPPLY & INSTALL NEW STEEL STUD WALLS, INCLUDING TOLL HEIGHT ANODISED ALUMINIUM FRAME GLAZING, ANODISED ALUMINIUM FRAME GLASS DOORS TO COMPUTER LAB, (REFER TO WALL SET-OUT PLANS & GLAZING SCHEDULES FOR DETAILS)
- [11] SUPPLY & INSTALL NEW STEEL STUD WALLS, FIXED GLAZING TO BOOKSHOP. SUPPLY & INSTALL ANODISED ALUMINIUM FRAME AS REQUIRED TO SUIT SHOP-FRONT SLIDING DOOR OPENING.
- [12] [PC ITEM] SUPPLY & INSTALL NEW 2600MM HIGH SHOP-FRONT TYPE SLIDING DOOR & LOCK TO SUIT OPENING SUIT SHOP-FRONT SLIDING DOOR TO BE INSTALLED WITH MANUFACTURERS RECOMMENDATION.
- [13] [PC ITEM] SUPPLY & INSTALL NEW EXTERIOR BENCH SEAT OUTSIDE COMPUTER LAB. DETAILS TO BE SELECTED AT A LATER DATE.

TENDER ISSUE

PROVARK ARCHITECTS
 278A HIGH STREET, KEW, VIC3101
 T: 9855-2567 F: 9855-2569 M: 0418 147 800

PROJECT
 SWINBURNE UNIVERSITY OF TECHNOLOGY
 LILVDALE CAMPUS
 LA BUILDING (TRIUM REDEVELOPMENT)
 STAGE 1

ADDRESS
 LILVDALE CAMPUS

DESCRIPTION
 FLOOR PLAN (L1)

| | | |
|------------|--------------------|------------|
| CLIENT | DRAWN | CHECKED |
| SUT | ST | PROVARK |
| TENDER NO. | JOB NO. | DATE DRAWN |
| 200819 | ----- | 9 SEP 2008 |
| PRDARK | DRAWING NO. | |
| A04 | CLIENT DRAWING NO. | |

PROPOSED FLOOR PLAN (LEVEL 1)

DO NOT SCALE DRAWING

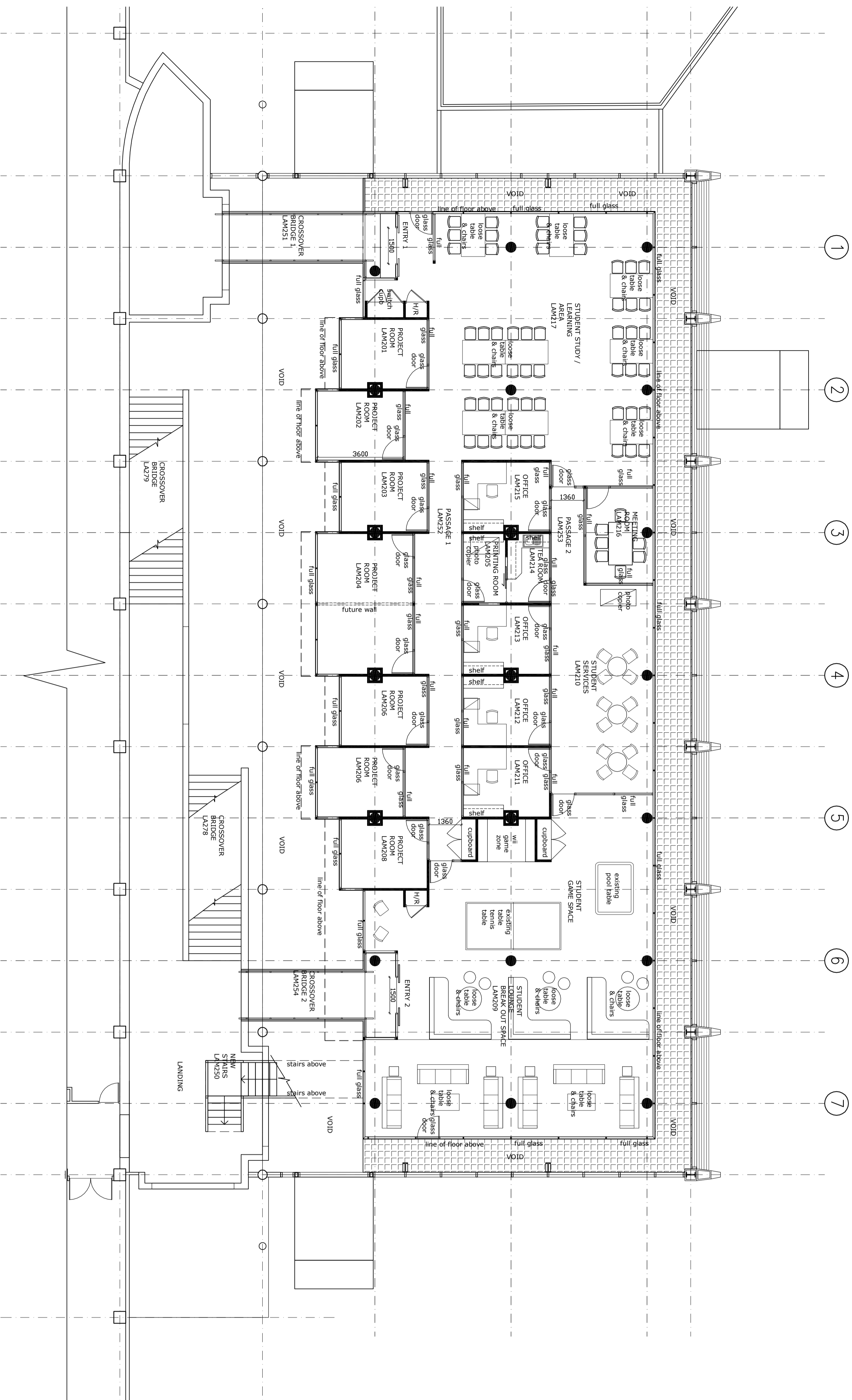

PROPOSED FLOOR PLAN (LEVEL 2)

ALL PC ITEMS ARE FOR INFORMATION ONLY. CONTRACTOR'S RESPONSIBILITY TO WORK WITH EXISTING SITE CONDITIONS INCLUDING EXISTING DIMENSIONS ON-SITE.

GENERAL NOTES:

CONTRACTOR TO CHECK AND CONFIRM DIMENSIONS AND SIZES OF ALL PRE-FABRICATED MATERIALS ON-SITE PRIOR TO ORDERING & INSTALLATION OF MATERIALS.

CONTRACTOR TO REFER TO STRUCTURAL ENGINEER'S DRAWINGS AND SPECIFICATIONS FOR ANY STRUCTURAL SCOPE OF WORKS AND REQUIREMENTS.

CONTRACTOR TO REFER TO ELECTRICAL ENGINEER'S DRAWINGS AND SPECIFICATIONS FOR ANY ELECTRICAL SCOPE OF WORKS AND REQUIREMENTS.

CONTRACTOR TO REFER TO MECHANICAL ENGINEER'S DRAWINGS AND SPECIFICATIONS FOR ANY MECHANICAL SCOPE OF WORKS AND REQUIREMENTS.

CONTRACTOR TO REFER TO HYDRAULIC ENGINEER'S DRAWINGS AND SPECIFICATIONS FOR ANY HYDRAULIC AND PLUMBING SCOPE OF WORKS.

CONTRACTOR TO REFER TO CIVIL ENGINEER'S DRAWINGS AND SPECIFICATIONS FOR ANY CIVIL SCOPE OF WORKS AND REQUIREMENTS.

IF UN-CLEAR REGARDING ANY PART OF SCOPE OF WORKS, CONTRACTOR'S RESPONSIBILITY TO CLARIFY WITH ARCHITECT PRIOR TO COMMENCING THE WORKS. CONTRACTOR'S RESPONSIBILITY TO RETRY THE WORKS IF CONTRACTOR CARRIED OUT THE WORKS WITH-OUT CONFIRMING WITH ARCHITECT AND RELEVANT CONSULTANTS.

ALL FIXED JOINERY SHOWN ARE FOR INFORMATION ONLY. (FACTORY) TO BE CHECKED AND CONFIRMED WITH ARCHITECT AFTER TENDER.

ALL LOOSE FURNITURES SHOWN ARE FOR INFORMATION ONLY, INCLUDING: TABLES, CHAIRS, RUBBERISH BINS, LOOSE ADJUSTABLE WHEELS, OFFICE WORKSTATION SCREENS, PIN-BOARDS, MOBILE METAL FILING CABINETS, MOBILE PEDESTALS.

ALL LOOSE FURNITURE TO BE TENDER OUT AS A SEPARATE CONTRACT AT A LATER DATE.

TENDER ISSUE

PROVARK
ARCHITECTS

278A HIGH STREET, KEW, VIC3101
T: 9855-2567 F: 9855-2569 M: 0418 147 800

PROJECT
SWINBURNE UNIVERSITY OF TECHNOLOGY
LILYDALE CAMPUS
LA BUILDING (ATRIUM REDEVELOPMENT)
STAGE 1

ADDRESS
LILYDALE CAMPUS

DESCRIPTION
FLOOR PLAN (L2)

| | | |
|------------|--------------------|------------|
| CLIENT | DRAWN | CHECKED |
| SUT | ST | PROARK |
| TENDER NO. | JOB No. | DATE DRAWN |
| 200819 | ----- | 9 SEP 2008 |
| SCALE | PRDARK DRAWING No. | |
| 1:100@A1 | A05 | |
| | CLIENT DRAWING NO. | |

DO NOT SCALE DRAWING

ALL PC ITEMS ARE FOR INFORMATION ONLY. PC ITEMS IS SHOWN AS PC ITEMS (PAGE 2) AND NOT TO BE INCLUDED IN THE TENDER PRICE. REFER TO SPEC. FOR DETAILS.

GENERAL NOTES:

IT IS CONTRACTOR'S RESPONSIBILITY TO WORK WITH EXISTING SITE CONDITIONS INCLUDING EXISTING DIMENSIONS ON-SITE.

CONTRACTOR TO CHECK AND CORRECT DIMENSIONS AND SIZES OF ALL PRE-FABRICATED MATERIALS ON-SITE PRIOR TO ORDERING & INSTALLATION OF MATERIALS.

CONTRACTOR TO REFER TO STRUCTURAL ENGINEER'S DRAWINGS AND SPECIFICATIONS FOR ANY MECHANICAL SCOPE OF WORKS AND REQUIREMENTS.

CONTRACTOR TO REFER TO ELECTRICAL ENGINEER'S DRAWINGS AND SPECIFICATIONS FOR ANY ELECTRICAL SCOPE OF WORKS AND REQUIREMENTS.

CONTRACTOR TO REFER TO HYDRAULIC ENGINEER'S DRAWINGS AND SPECIFICATIONS FOR ANY HYDRAULIC AND PLUMBING SCOPE OF WORKS.

CONTRACTOR TO REFER TO MECHANICAL ENGINEER'S DRAWINGS AND SPECIFICATIONS FOR ANY MECHANICAL SCOPE OF WORKS AND REQUIREMENTS.

CONTRACTOR TO REFER TO CIVIL ENGINEER'S DRAWINGS AND SPECIFICATIONS FOR ANY CIVIL SCOPE OF WORKS AND REQUIREMENTS.

IF UN-CL-AR REGARDING ANY PART OF SCOPE OF WORKS, CONTRACTOR'S MUST CONTACT ARCHITECT OR RELEVANT CONSULTANTS FOR CLARIFICATIONS PRIOR TO COMMENCING THE WORKS.

IT IS CONTRACTOR'S RESPONSIBILITY TO RETRY WORKS WITH-OUT CONFERMING WITH ARCHITECT AND RELEVANT CONSULTANTS.

ALL FIXED JOINERY SHOWN ARE FOR INFORMATION ONLY. (PC ITEM) TO BE CHECKED DETAILS OF ALL FIXED JOINERY TO BE CHECKED AND CONFIRMED WITH ARCHITECT AFTER TENDER.

ALL LOOSE FURNITURES SHOWN ARE FOR INFORMATION ONLY, INCLUDING, TABLES, CHAIRS, RUBBISH BINS, LOOSE ADJUSTABLE SHELVES, OFFICE WORKSTATION SCREENS, WORKSTATION DESKS, WHITEBOARDS, MOBILE PEDESTALS, THE ALL TILING CABINETS, ALL LOOSE FURNITURE TO BE TENDER OUT AS A SEPARATE CONTRACT AT A LATER DATE.

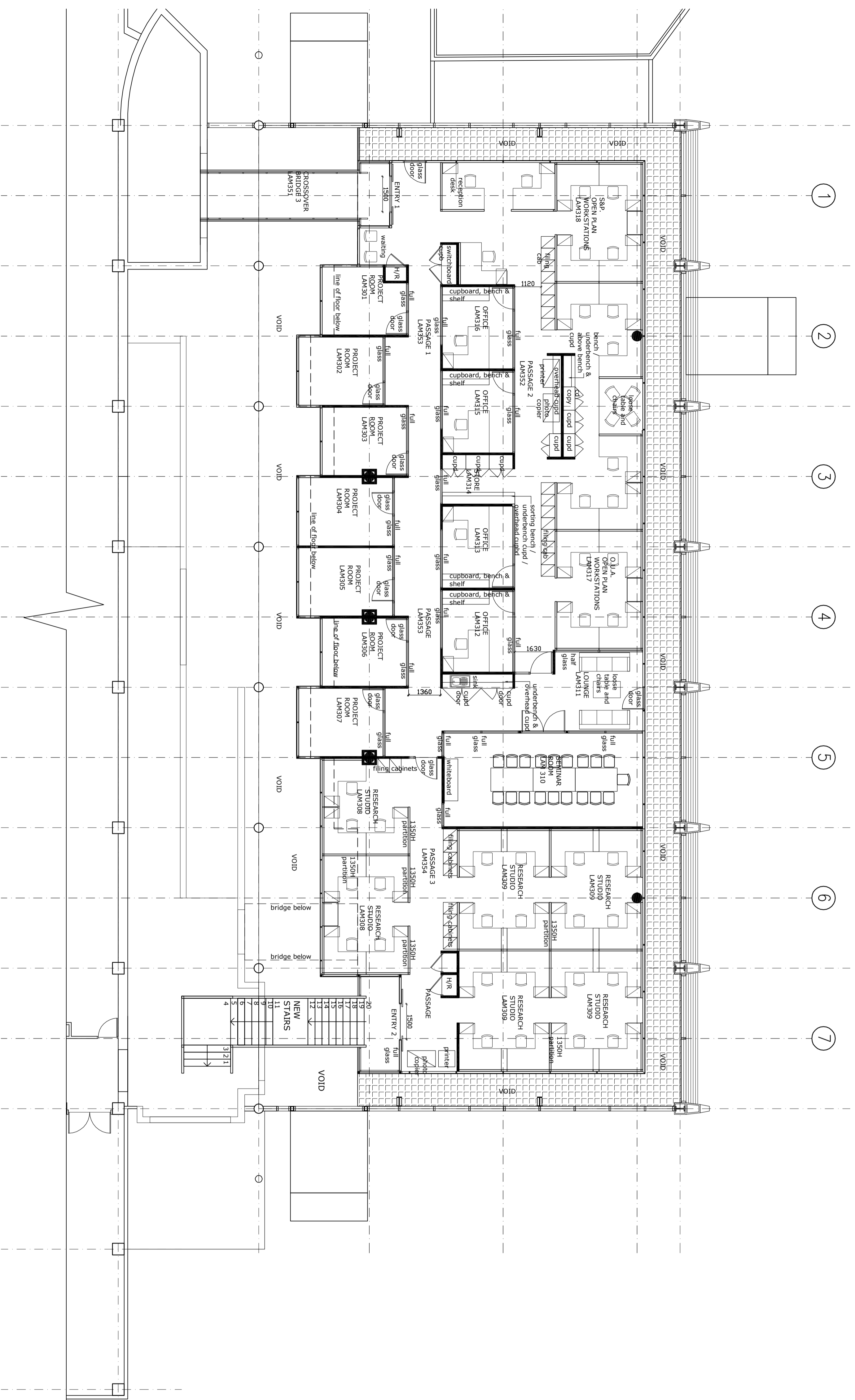

PROPOSED FLOOR PLAN (LEVEL 3)

TENDER ISSUE

PROVARK
ARCHITECTS

278A HIGH STREET, KEW, VIC3101
T: 9855-2567 F: 9855-2569 M: 0418 147 800

PROJECT
SWINBURNE UNIVERSITY OF TECHNOLOGY
LILYDALE CAMPUS
LA BUILDING (ATRIUM REDEVELOPMENT)
STAGE 1

ADDRESS
LILYDALE CAMPUS

DESCRIPTION
FLOOR PLAN (L3)

| | | |
|------------|--------------------|------------|
| CLIENT | DRAWN | CHECKED |
| SUT | ST | PROARK |
| TENDER NO. | JOB NO. | DATE DRAWN |
| 200819 | ----- | 9 SEP 2008 |
| SCALE | PRDARK DRAWING NO. | |
| 1:100@A1 | A06 | |
| | CLIENT DRAWING NO. | |

DO NOT SCALE DRAWING